

Repair Kits

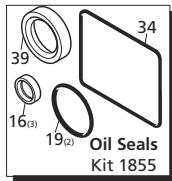
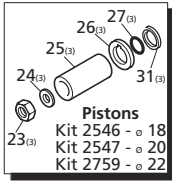

Special Parts / Kits

Code	Description	Qty.
2809	Viton water seals $\phi 18$	1
2810	Viton water seals $\phi 20$	1
2811	Viton water seals $\phi 22$	1
2819	Kit for up to 180° F $\phi 18$ High Temp	1
2820	Kit for up to 180° F $\phi 20$ High Temp	1
1837	Rail Kit 5/8" - 2 Rails & 4 Bolts	1
2633	Rail Kit 1-3/4" - 2 Rails & 4 Bolts	1
2633H	Rail Kit 2-5/8" - 2 Rails & 4 Bolts	1

Pos	Code	Description	Qty.	Pos	Code	Description	Qty.	Pos	Code	Description	Qty.	
1	960160	O-Ring $\phi 17.86 \times 2.62$	6	26	1380950	Spacer	3	77	840370	Bearing	1	
2	960090	Valve cap - Brass (478 in/lbs)	6	27	600180	O-Ring $\phi 7.66 \times 1.78$	3	78	1389270	Complete pump head $\phi 18$ H	1	
3	960850	Valve cap - SS (478 in/lbs)	6	28	1380920	Guiding piston	3	79	1389272	Complete pump head $\phi 18$ H	1	
4	1380740	Valve cap - NP (478 in/lbs)	6	29	1380060	Piston pin	3	80	1389271	Complete pump head $\phi 18$ H	1	
5	960090T	Valve cap - 1/4" threaded - Brass (478 in/lbs)	1	30	1383020	Con rod - Bronze > 3000 PSI	3	81	1389212	Complete pump head $\phi 20$ H	1	
6	960850T	Valve cap - 1/4" threaded - SS (478 in/lbs)	1	31	1383050	Con rod - Aluminum < 3000 PSI	3	82	1389220	Complete pump head $\phi 22$ H	1	
7	1389051	Complete valve	6	32	1080401	Back-up ring	3	83	86	1260250	Oil sight glass	1
8	880830	O-Ring $\phi 15.54 \times 2.62$	6	33	1381850	Washer	8	84	87	1260430	Snap ring	1
9	880581	Plug 1/4" G - Brass	2	34	1780510	O-Ring	1	85	88	1780690	Contrast disc	1
10	1380690	Plug 1/4" G NP	2	35	1789010	Complete cover	1	86	89	1140450	O-Ring $\phi 20.24 \times 2.62$	1
11	820510	O-Ring $\phi 10.82 \times 1.78$	2	36	1343510	Bolt M6x14 (89 in/lbs)	6	AR64516 Oil			1	
12	960110	Support ring $\phi 18$	3	37	2280070	Crankshaft 24mm	1	OIL CAPACITY - 15 oz				
13	840300	Support ring $\phi 20$	3	38	2280060	Crankshaft 24mm	1	Legend				
14	840320	Support ring $\phi 22$	3	39	1380520	Key	1	$\phi 18$	$\phi 20$	$\phi 22$		
15	880320	High pressure packing $\phi 18$	3	40	180340	Oil seal	1	For ■	For □	For ★		
16	840290	High pressure packing $\phi 20$	3	41	1380120	Shim 0.10 mm	1-3	RK15.15	RK18.20H	RK21.20H		
17	840330	High pressure packing $\phi 22$	3	42	1380130	Shim 0.20 mm	1-3	RK15.20H	RK18.28H			
18	1380090	Piston guide $\phi 18$	3	43	1380530	Shim 0.25 mm	1-3	RK15.28H				
19	1380150	Piston guide $\phi 20$	3	44	1382810	Shim 0.05 mm	1-3					
20	1380160	Piston guide $\phi 22$	3	45	1380040	Open bearing support (217 in/lbs)	1					
21	961240	O-Ring $\phi 31.47 \times 1.78$	3	46	740290	O-Ring $\phi 14 \times 1.78$	3					
22	880330	Low pressure seal $\phi 18$	3	47	1980740	Plug 3/8" G	2					
23	840280	Low pressure seal $\phi 20$	3	48	1981180	Plug 3/8" G NP	1					
24	840340	Low pressure seal $\phi 22$	3	49	180101	O-Ring $\phi 17.5 \times 2$	1					
25	1383130	Oil seal	3	50	820361	Plug 1/2" G	1					
	17	850370	Bolt M8x16 (217 in/lbs)	8		960870	Plug 1/2" G NP	1				
	18	1380050	Closed bearing support	1		1381070	Pump head - NP $\phi 18$	1				
	19	640030	O-Ring $\phi 59.99 \times 2.62$	2		1381071	Pump head - Brass $\phi 18$	1				
	20	2280240	Bearing	1		1380020	Pump head - Brass $\phi 20-22$	1				
	21	1382770	Pump housing	1		1380680	Pump head - NP $\phi 20-22$	1				
	22	880130	Vented oil cap	1		820150	Head bolt M8x70 (217 in/lbs)	8				
	23	962010	Nut M8 (106 in/lbs)	3								
	24	962000	Washer $\phi 8.1$	3								
	25	1380940	Ceramic piston $\phi 18$	3								
		1380930	Ceramic piston $\phi 20$	3								
		1382360	Ceramic piston $\phi 22$	3								